

COUNCIL ACTION FORM

SUBJECT: U.S. HIGHWAY 30 DETOUR AGREEMENTS

BACKGROUND:

The Iowa Department of Transportation (DOT) will be reconstructing portions of U.S. Highway 30 during 2011. To facilitate the construction activities in the area, the Iowa DOT has determined that it is necessary to detour **westbound traffic** for two separate stages.

From May 19, 2011 until no later than August 15, 2011, detoured westbound US 30 traffic would utilize South Duff Avenue, South 16th Street, and University Boulevard.

From August 15, 2011 until no later than November 15, 2011, detoured westbound US 30 traffic would utilize South Dakota Avenue and western Lincoln Way.

The traffic control and the detour routes will be maintained by the Iowa DOT during the detour period. Engineers from the City of Ames and the Iowa DOT will jointly inspect the routes to determine the existing condition of the roadway surface, base, shoulders, and structures prior to the detour. Upon completion of the work, the Iowa DOT will be responsible for restoring the roadways to at least the previous condition or making appropriate compensation to the City of Ames.

ALTERNATIVES:

1. Approve the U.S. Highway 30 detour agreements with the Iowa DOT.
2. Do not execute the detour agreements, thus necessitating the Iowa DOT to redevelop construction staging and traffic control plans.

MANAGER'S RECOMMENDED ACTION:

The proposed detours will allow the Iowa DOT to expedite the construction activities on U.S. Highway 30 while providing for the most effective management of traffic during the construction period. While public notification will be the responsibility of the Iowa DOT, the City will assist with public awareness efforts.

Therefore, it is the recommendation of the City Manager that the City Council adopt Alternative No. 1, thereby approving the U.S. Highway 30 detour agreements with the Iowa DOT.

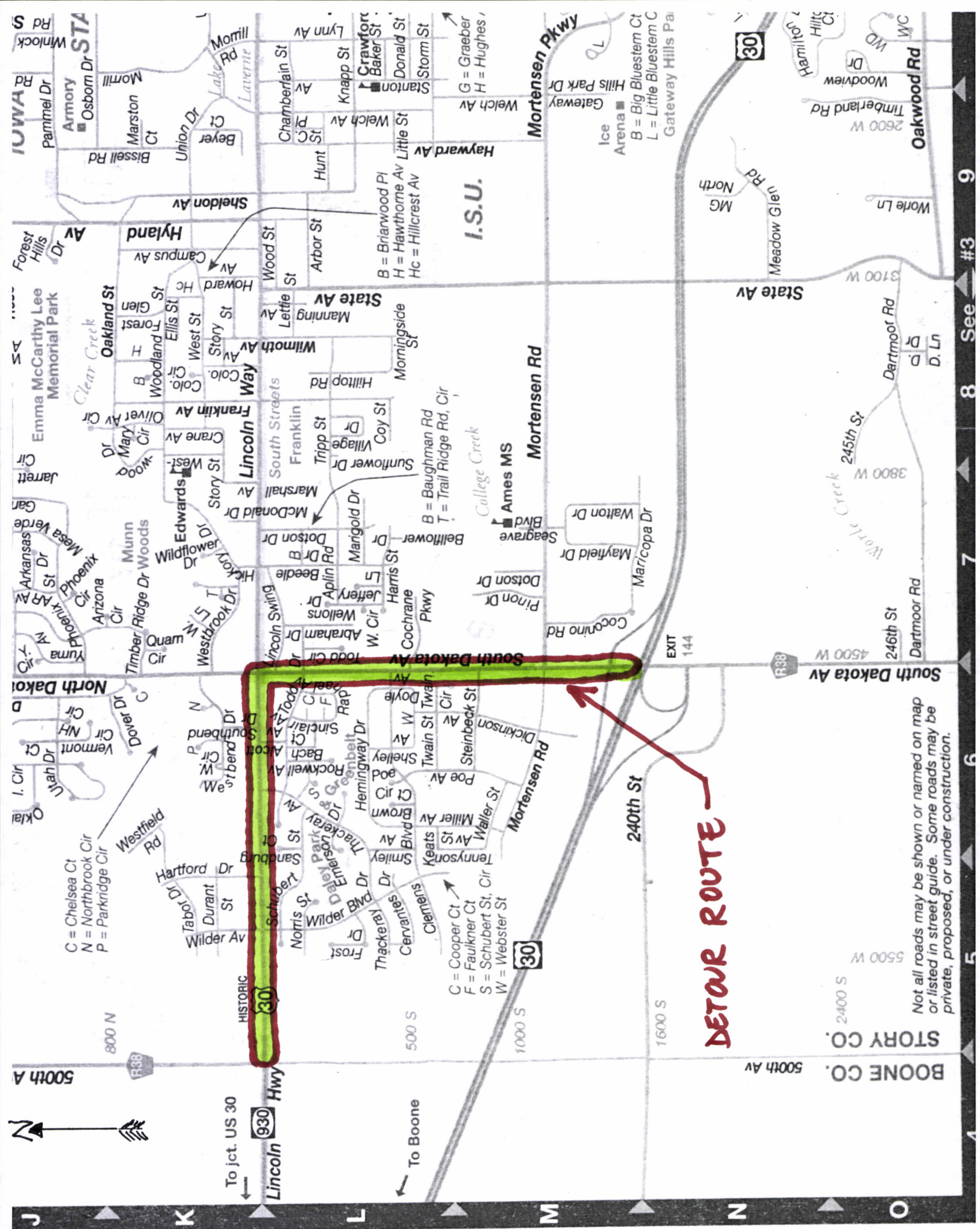

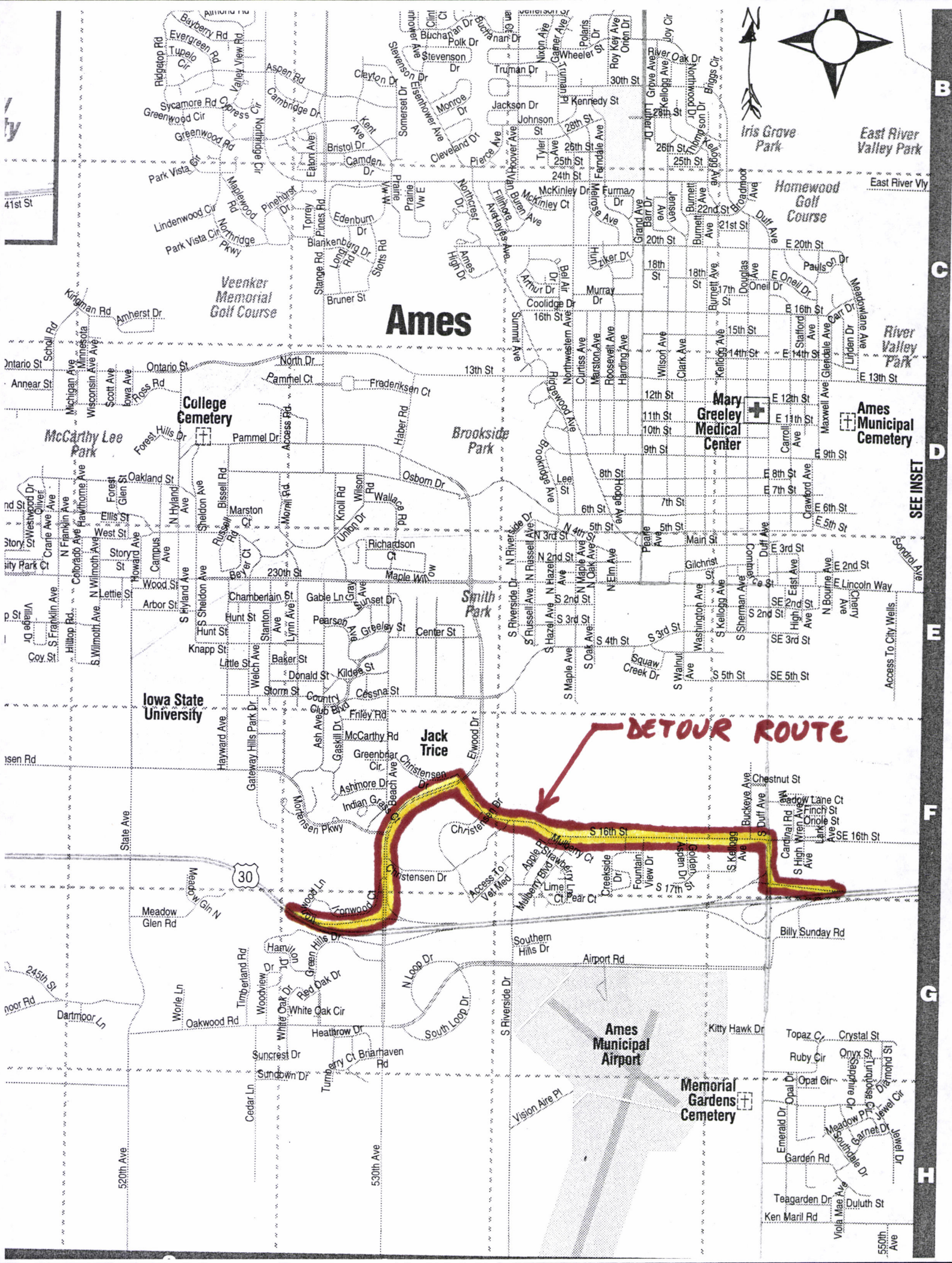

Ames

College Cemetery

Mary Greeley Medical Center

Ames Municipal Cemetery

Iowa State University

Jack Trice

DETOUR ROUTE

Ames Municipal Airport

Memorial Gardens Cemetery

SEE INSET

F

G

H

B

C

D

E

F

G

H